

Andrea Rossi | Architect and Environmental Consultant

@. andrearossi.jmy@gmail.com | m. +44-(0)7387812245 or +39-3462196241 | dob. 31-05-1987



Summary

Andrea Rossi is an architect specialised in sustainable environmental design (MArch at the Architectural Association School of Architecture). Andrea currently works as Architect and Environmental Consultant being constantly involved in architecture competitions and private design commissions and he has more than 5 years of experience. Registered as an architect in UK and Italy and chartered member of the RIBA, Andrea has joined ChapmanBDSP since 2013 and has previously collaborated among others with Kengo Kuma and Associates Europe and Studio Pession Associato. Andrea is Visiting Lecturer at Polytechnic University of Turin School of Architecture and worked as Teaching Assistant since 2013. Andrea received recently the Best Poster Award at PLEA 2015 Architecture in (R)evolution international conference.

Languages

Italian | English | Spanish | French

ARB | Architects Registration Board
RIBA | Royal Institute of British Architects
AA | Architectural Association
OAT | Ordine Architetti Torino

Education

MArch Sustainable Environmental Design | Architectural Association | London, UK | 2015
Master of Architecture | Polytechnic University of Turin | Torino, IT | 2012
ERASMUS Program | KTH - Kungliga Tekniska Högskolan | Stockholm, SWE | 2010-11
Bachelor of Architecture | Polytechnic University of Turin | Torino, IT | 2009

Selected Experience

Environmental Consultant at ChapmanBDSP | since 2015 | London, UK



LSE - Paul Marshall Building
Grafton Architects
London, UK | 2016

Status | Ongoing

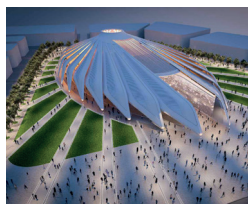

UAE Pavilion at Dubai World Expo 2020
Santiago Calatrava A&E
Dubai, UAE | 2016

Status | Ongoing



The Tower DCH
Santiago Calatrava A&E
Dubai, UAE | 2016

Status | Under construction



D3 - Dubai Design District
Foster + Partners
Dubai, UAE | 2015

Commission | Private commission
Status | Ongoing



Boulevard Heights
Perkins + Will
Dubai, UAE | 2014

Commission | Private Commission
Status | Under Construction



Battersea Power Station - Phase3
Foster + Partners, Gehry Partners
London, UK | 2013

Commission | Private commission
Status | Under construction



Institut Mines Télécom
Grafton Architects
Paris, FR | 2013

Commission | Competition, first prize
Status | Under construction



LSE - Center Building Redevelopment
Rogers Stirk Harbour + Partners
London, UK | 2013

Commission | Competition, first prize
Status | Under construction



Battersea Power Station - Phase2
Wilkinson Eyre Architects
London, UK | 2013

Commission | Private commission
Status | Under construction

Freelance Architect | since 2011



Innovative Schools
Palermo, IT | 2016

Commission | Competition
Status | Idea



Attic conversion into family house
Beinasco, IT | 2016

Commission | Private commission
Status | Ongoing



Io (C)entro - UNIPOL SAI front office
Beinasco, IT | 2016

Commission | Private commission
Status | Ongoing



Agenzia 2.0-08 - UNIPOL SAI front office
Torino, IT | 2016

Commission | Private commission
Status | Completed



UNIPOL-SAI executive offices
Torino, IT | 2014

Commission | Private commission
Status | Completed



stcRIO - Sustainable Transport Centre
Rio de Janeiro, BRA | 2012

Commission | Competition, honourable mention
Status | Idea



Da Montesinaro all'Alpe Fontana
Pié di Cavallo, IT | 2011

Commission | Competition, third prize
Status | Idea

Freelance Environmental Consultant | 2014 | Torino, IT



Veterinary University of Lodi
Kengo Kuma & Associates
Lodi, IT | 2014

Commission | Private commission
Status | Under construction

Architect at Studio Pession Associato | 2011-2013 | Torino, IT



Italian Pavilion at EXPO Milan 2015
Milan, IT | 2013

Commission | Competition
Status | Idea



NUV - New University of Valle d'Aosta
with Mario Cucinella Architects
Aosta, IT | 2012

Commission | Competition, first prize
Status | Ongoing

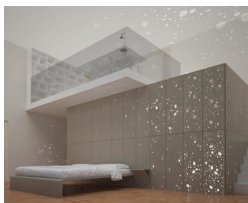

Apartment Renovation in Palazzo Adrovandi-Montanari
Bologna, IT | 2012

Commission | Private commission
Status | Completed



ENI Exploration and Production Headquarter
with BIG - Bjarke Ingels Group
San Donato Milanese, IT | 2011

Commission | Competition, finalist
Status | Idea

Furniture Designer at Alfredo Bongiovanni SNC | 2011 | Torino, IT



Squelette Collection
Torino, IT | 2011

Commission | Private commission
Status | Completed

Intern at Studio Pession Associato | 2010 | Torino, IT



La Metamorfofi - Spina IV
with Buffi Associés
Torino, IT | 2010

Commission | Competition, special mention
Status | Idea

	Intern at Immobiliare Carando 2008 Torino, IT Craftsman at Immobiliare Carando 2004 Torino, IT
Academic	Visiting Lecturer at Polytechnic University of Turin Torino, IT since 2014 Teaching Assistant at Polytechnic University of Turin Torino, IT 2013
Awards	'LabGrade' sustainable design competition 1st Prize 2016 'PLEA 2015 Architecture in (R)evolution' conference Best Poster Award 2015 'Da Montesinaro all'Alpe Fontana' competition Third Prize 2011 'stcRIO' international design competition Honourable Mention 2012
Publications	'Migrant centre and primary school in Lampedusa (IT)' in Proceedings of PLEA 2015 'En samekåta modell störré' in Trä Information n.3 2011
Skills	Rhinoceros Advanced Grasshopper Advanced Ladybug+Honeybee+Butterfly Advanced Revit Intermediate AutoCAD Advanced 3DS Max Intermediate Sketchup Advanced Vray Intermediate Ecotect Advanced DIVA Advanced Radiance Advanced Daysim Advanced EDSL TAS Advanced Energy Plus Intermediate Flow Design Advanced Win Air Advanced Adobe Photoshop Advanced Adobe Illustrator Advanced Adobe InDesign Advanced Microsoft Office/iWork Advanced Digital Fabrication Intermediate Model Making Intermediate
Personal Skills	Willingness to respond to circumstances and work extra hours if required Pro-active approach to work Ability to manage, prioritize and plan effectively with good problem solving skills Able to work as part of a team (interacting with all team members) or individually Good communication and presentation skills Flexible and willing to travel
References	Prof. Dr. Simos Yannas E&E Studies Programme Director Architectural Association 34-36 Bedford Square, WC1B, London, UK +44-(0)2078874000 simos@aa.school.ac.uk Prof. Arch. Sara Grahn Partner at White Arkitekter and Professor at KTH Sustainable Design Studio 100 44 Stockholm, SWE +46-87908584 sara.grahn@white.se Arch. Emanuele Pession Partner at Studio Pession Associato Corso Galileo Ferraris 60, 10129, Torino, IT +39-011501966 emanuele@pession.it